

PARTS LIST & MATERIAL

ITEM No.	DESCRIPTION	Q'TY	MATERIALS
17	BODY	1	SCS13A
20	CLOSURE	1	SCS13A
21	GASKET - BODY TO CLOSURE	1	PTFE
22	STUD BOLT	4	S.S 304
23	HEX NUT	4	S.S 304
19	BALL	1	S.S 304
18	SEAT	2	PTFE
11	STEM	1	S.S 304
13	BEARING	1	PTFE
14	THRUST WASHER	1	PTFE
2	THRUST WASHER	1	PTFE
15	ANTI-STATIC PIN	1	S.S 316
16	ANTI-STATIC SPRING	1	S.S 316
12	PACKING	1	PTFE
1	PACKING WASHER	1	S.S 316
9	GLAND	1	SCS13A
6	SCREW - GLAND	2	S.S 304
10	BUSHING	1	PTFE
8	STOPPER	1	S.S 304
5	WRENCH	1	STEEL + Zn PLATED
3	SCREW-WRENCH	1	S.S 304
4	WASHER-WRENCH	1	S.S 304
7	SNAP RING	1	S.S 304

MATERIAL SELECTION	
BODY & BALL	SEAT
CF8, SCS13	Glass 15% PTFE (Std.)
WCB, SCPH2	Graphite 15% PTFE
CF8M, SCS14	Carbon 25% PTFE
CF3M, SCS16	Carbon Fiber
CF3, SCS19	PEEK
LCB, SCPL1	Soft PEEK
A105	TFM PTFE
F304	PCTFE
F316	...
CD4MCuN	
CN7M	
CW-6M	
...	

PRESSURE & TEMP.

10K-Class 150 - 2 piece Design
PTFE Seats

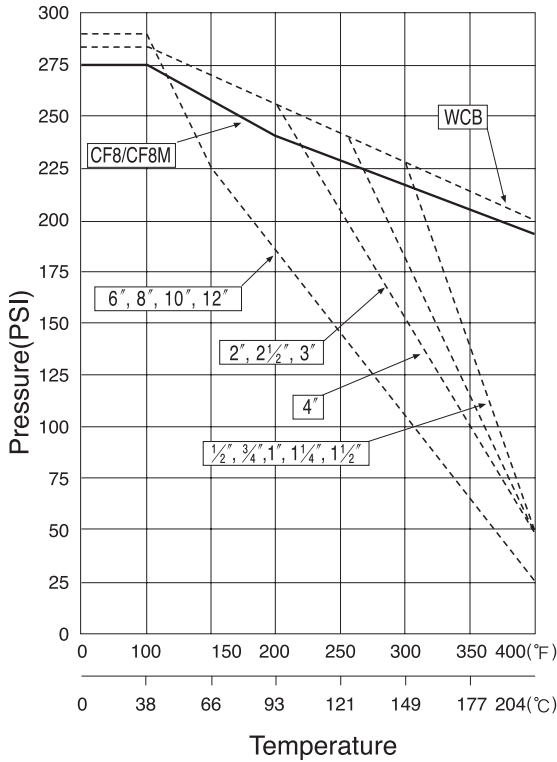

10K-Class 150 - 2 piece Design
Glass or Carbon Reinforced PTFE Seats

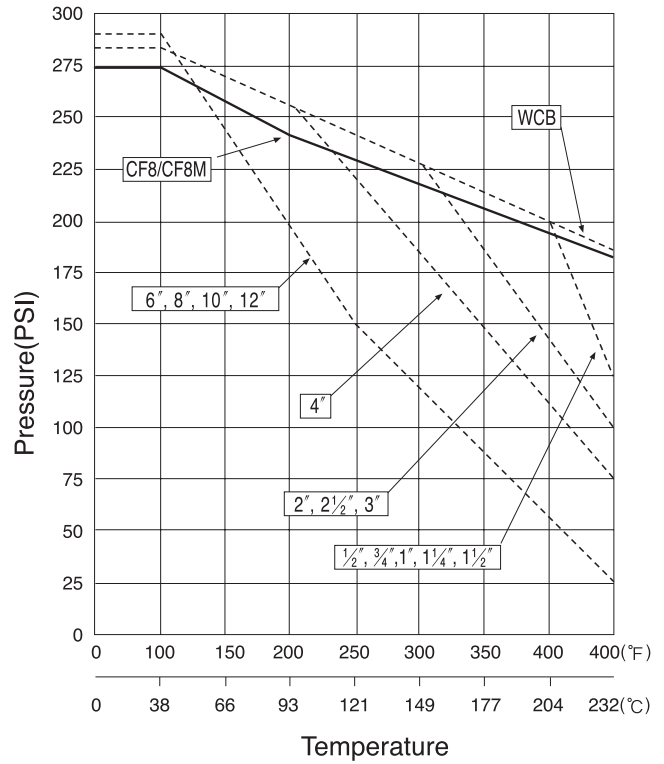

20K-Class 300 - 2 piece Design
PTFE Seats

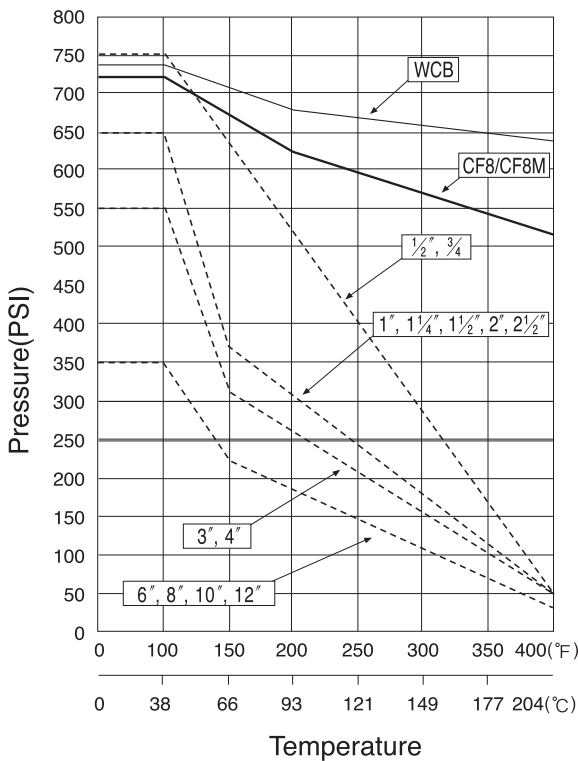

20K-Class 300 - 2 piece Design
Glass or Carbon Reinforced PTFE Seats

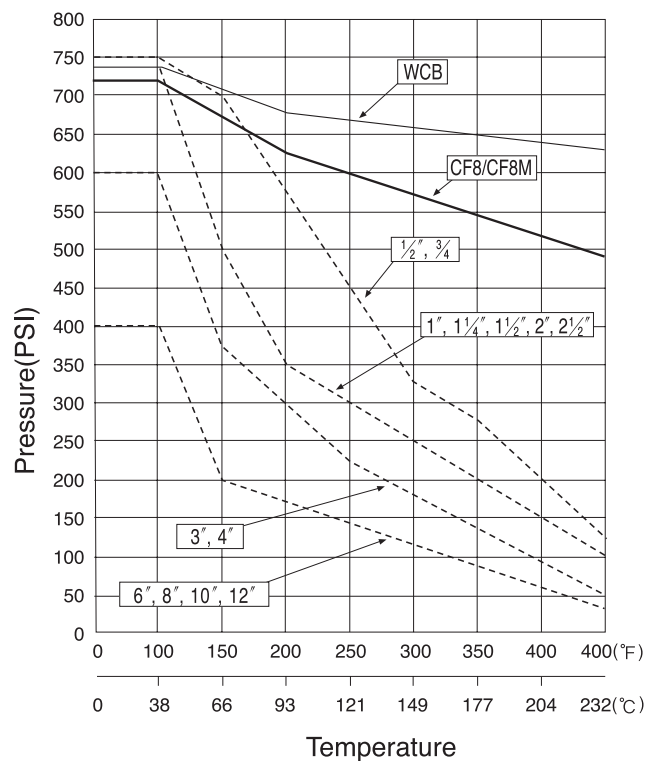

< PNEUMATIC >

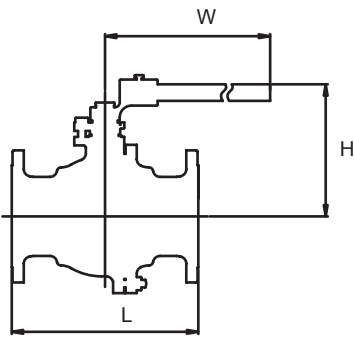
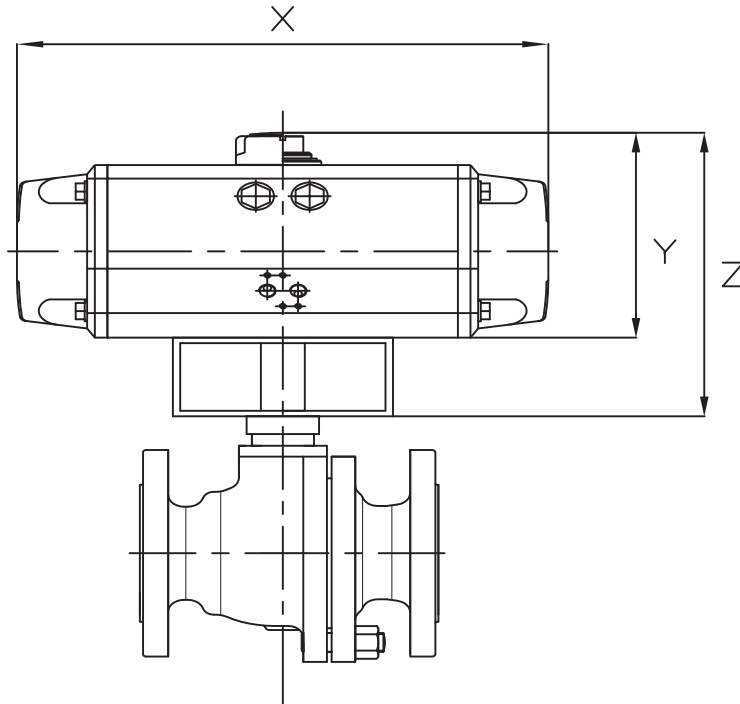

Size 1/2" (15) to 8" (200)

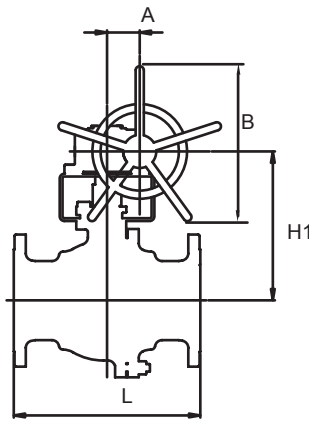

Size 6" (150) to 8" (200)
Gear Operated (Option)

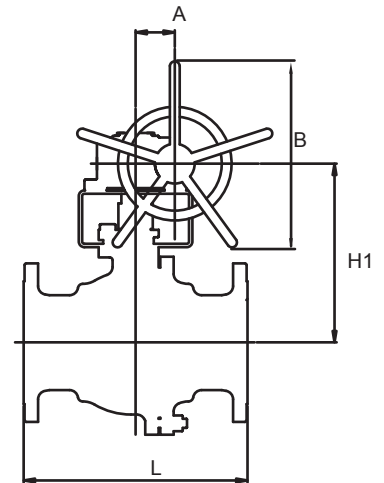

Size 10" (250) to 12" (300)

Valve Size	L		H	H1	W	A	B	X	Y	Z
	ANSI 150# JIS 10K	ANSI 300# JIS 20K								
1/2 (15)	4.25 (108)	5.5 (140)	2.8 (71)	-	5.12 (130)	-	-			
3/4 (20)	4.625(117)	6 (152)	2.88 (73)	-	5.12 (130)	-	-			
1 (25)	5 (127)	6.5 (165)	3.15 (80)	-	6.3 (160)	-	-			
1-1/4 (32)	5.5 (140)	7 (178)	3.23 (82)	-	6.3 (160)	-	-			
1-1/2 (40)	6.5 (165)	7.5 (190)	4.61 (117)	-	9.06 (230)	-	-			
2 (50)	7 (178)	8.5 (216)	4.89 (124)	-	9.06 (230)	-	-			
2-1/2 (65)	7.5 (190)	9.5 (241)	6.54 (166)	-	15.75 (400)	-	-			
3 (80)	8 (203)	11.125(283)	6.93 (176)	-	15.75 (400)	-	-			
4 (100)	9 (229)	12 (305)	8.11 (206)	-	18.11 (460)	-	-			
5 (125)	10 (256)	15 (381)	8.78 (223)	-	18.11 (460)	-	-			
6 (150)	15.5 (394)	15.875(403)	11.46 (291)	16.62(422)	39.37(1000)	0.4 (10)	8.27(210)			
8 (200)	18 (457)	19.75 (502)	14.06 (357)	20.36(517)	59.06(1500)	0.4 (10)	8.27(210)			
10 (250)	21 (533)	22.375(568)	-	22.64(575)	-	0.59(15)	12.21(310)			
12 (300)	24 (610)	25.5 (648)	-	25 (635)	-	0.59(15)	12.21(310)			

inch (mm)

* OPERATING TIME : OPTION (0.2 ~ 20 SEC)

< ELECTRIC >

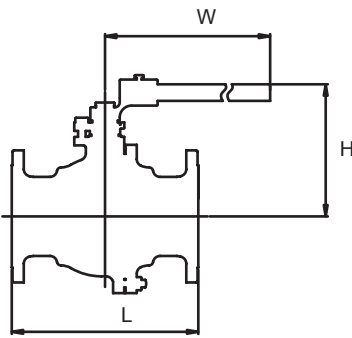
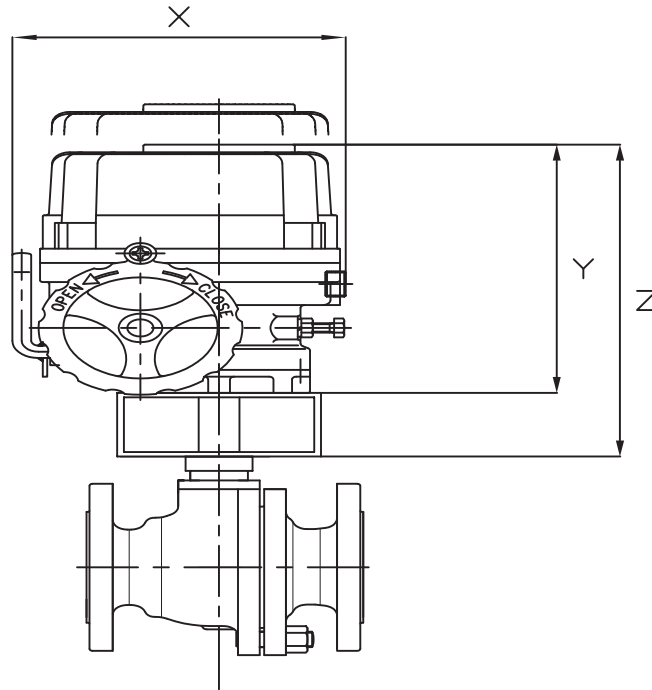

Size 1/2" (15) to 8" (200)

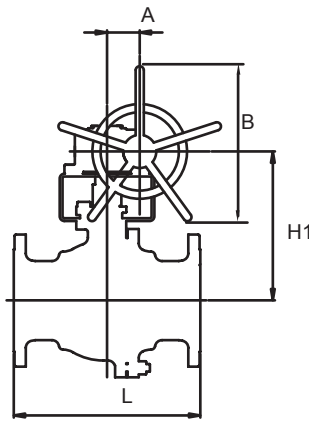

Size 6" (150) to 8" (200)
Gear Operated (Option)

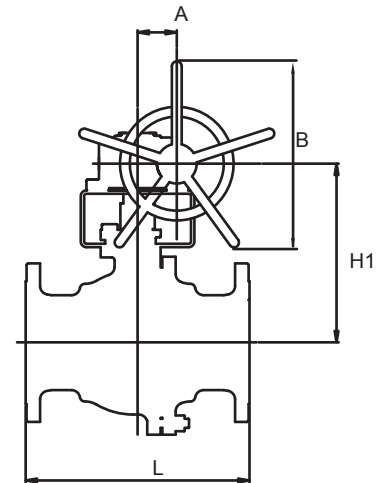

Size 10" (250) to 12" (300)

inch (mm)

Valve Size	L		H	H1	W	A	B	X	Y	Z
	ANSI 150# JIS 10K	ANSI 300# JIS 20K								
1/2 (15)	4.25 (108)	5.5 (140)	2.8 (71)	-	5.12 (130)	-	-			
3/4 (20)	4.625(117)	6 (152)	2.88 (73)	-	5.12 (130)	-	-			
1 (25)	5 (127)	6.5 (165)	3.15 (80)	-	6.3 (160)	-	-			
1-1/4 (32)	5.5 (140)	7 (178)	3.23 (82)	-	6.3 (160)	-	-			
1-1/2 (40)	6.5 (165)	7.5 (190)	4.61 (117)	-	9.06 (230)	-	-			
2 (50)	7 (178)	8.5 (216)	4.89 (124)	-	9.06 (230)	-	-			
2-1/2 (65)	7.5 (190)	9.5 (241)	6.54 (166)	-	15.75 (400)	-	-			
3 (80)	8 (203)	11.125(283)	6.93 (176)	-	15.75 (400)	-	-			
4 (100)	9 (229)	12 (305)	8.11 (206)	-	18.11 (460)	-	-			
5 (125)	10 (256)	15 (381)	8.78 (223)	-	18.11 (460)	-	-			
6 (150)	15.5 (394)	15.875(403)	11.46 (291)	16.62(422)	39.37(1000)	0.4 (10)	8.27(210)			
8 (200)	18 (457)	19.75 (502)	14.06 (357)	20.36(517)	59.06(1500)	0.4 (10)	8.27(210)			
10 (250)	21 (533)	22.375(568)	-	22.64(575)	-	0.59(15)	12.21(310)			
12 (300)	24 (610)	25.5 (648)	-	25 (635)	-	0.59(15)	12.21(310)			

* OPERATING TIME : OPTION (13 ~ 100 SEC)

(주) HK CONTROMATIC

TEL : 02) 2678 - 6264

FAX : 02) 2678 - 6396

E-MAIL : kwvalve@hanmail.net

<http://www.kwvalve.co.kr>