

S/520, S/521, S/522, S/523, S/524, S/532

Heavy duty non-return valves

G 1/8 ... G 1

Permit free flow of air in one direction only

Simple, reliable design

High operating pressure



Technical features

Medium:

Compressed air, filtered, lubricated and non-lubricated

Operation:

Heavy duty non-return valves

Operating pressure:

0,3 ... 16 bar (4,35 ... 232 psi)

Cracking pressure:

< 0,1 bar (1,45 psi)

Port sizes:

G1/8 ... G1, 1/8 ... 1 NPT

Mounting:

Line mounted

Fluid/Ambient temperature:

-20 ... +80°C max. (-4 ... +176°F max.)

Air supply must be dry enough

to avoid ice formation at

temperatures below +2°C (+35°F)

150°C (302°F) maximum

For high temperature applications

Materials

Body: brass

Valve: aluminium

Seals: nitrile rubber

Note: FKM Seals for high temperature version

Technical data, standard models

Symbol	Port size	Flow factor C *1)	Cv	Kv *2)	Weight (kg)	Service kit	Model
	G1/8	2,4	0,6	0,51	0,04	QS/520/00	S/520
	G1/4	4,3	1	0,92	0,09	QS/521/00	S/521
	G3/8	10,5	2,6	2,24	0,14	QS/532/00	S/532
	G1/2	17	4,2	3,62	0,21	QS/522/00	S/522
	G3/4	42	10,3	8,95	0,55	QS/523/00	S/523
	G1	55,5	13,6	11,8	1,10	QS/524/00	S/524

*1) Measured in dm³/(s.bar)

*2) Measured in m³/h

Options selector

Design	Substitute
Standard	None
High temperature (150 °C)	T
Thread form	Substitute
NPT	C
ISO G, parallel	S

★★/5★★

Port size	Substitute
1/8"	20
1/4"	21
3/8"	32
1/2"	22
3/4"	23
1"	24

S/520, S/521, S/522, S/523, S/524, S/532
 Heavy duty non-return valves
 G 1/8 ... G 1

Dimensions

Dimensions shown in mm
 Projection/First angle

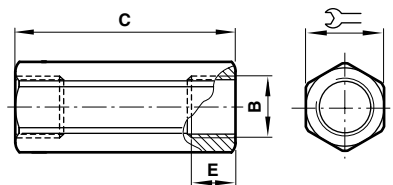

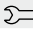
B	C	B	E		Model
G1/8	43	1/8	10	14	S/520
G1/4	48	1/4	11	19	S/521
G3/8	62	3/8	13	22	S/532
G1/2	76	1/2	17	27	S/522
G3/4	92	3/4	18	36	S/523
G1	124	1	25	49	S/524