

M/S.

Porous plastic silencers
M5, G1/8B ... G1B

Reduce the noise levels of pneumatic equipment

Compact, efficient and lightweight

Screw directly into the exhaust port

Prevent the ingress of dirt

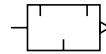

Technical features

Medium:

Compressed air, filtered 50 µm, lubricated and non lubricated/vacuum, inert gases

Operation:

Exhaust silencer/vacuum filter

Operating pressure:

-1 ... +10 bar maximum
[-14 ... 145 psi] (vacuum service)

Port sizes:

M5, G 1/8 ... G1
1/8 NPT ... 1 NPT

Mounting:

Directly in exhaust port

Fluid/Ambient temperature:

-20 ... +80°C [-4 ... +176°F]
Air supply must be dry enough to avoid ice formation at temperatures below +2°C [+35°F].

Materials

Body: UHMW polyethylene porous plastic
Connector base: polyethylene

Technical data, standard models

Symbol	Port size	Mean flow factor			Sound pressure level *3)	Model
		C *1	Cv	Kv *2		
	M5	1,27	0,31	0,27	83	M/S0
	G1/8B	4,1	1	0,87	84	M/S1
	G1/4B	7,5	1,84	1,6	84	M/S2
	G3/8B	16,2	4	3,45	81	M/S3
	G1/2B	21,8	5,3	4,64	82	M/S4
	G3/4B	32,8	8	7	98	M/S6
	G1B	49,8	12,2	10,6	94	M/S8

*1) Measured in dm³/ (s.bar)

*2) Measured in m³/h

*3) Measured in dBA/6bar/1 meter from unit

Option selector

★/S★

Thread form	Substitute
ISO G, parallel	M
NPT	C

Port size	Substitute
M5	0
1/8"	1
1/4"	2
3/8"	3
1/2"	4
3/4"	6
1"	8

M/S.
Porous plastic silencers
M5, G1/8B ... G1B

Dimensions

Dimensions shown in mm

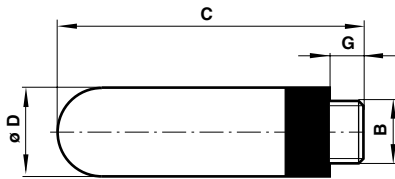

B	C	Ø D	G	Weight (g)	Model
M5	23	6,5	4	0,4	M/S0
G1/8B	34	12,5	6,5	1,65	M/S1
G1/4B	42,5	15,5	8	3,5	M/S2
G3/8B	67,5	18,5	11	6,0	M/S3
G1/2B	77,5	23,3	11	10,5	M/S4
G3/4B	131,5	38,5	15	34	M/S6
G1B	161	49	20	54	M/S8